



**Easter Seals Metropolitan Chicago**  
**1939 West 13th Street**  
**Chicago, IL 60608**  
**312-491-4110**



## **Overview of Easter Seals' Therapeutic School and Center for Autism Research**

Easter Seals Metropolitan Chicago (ESMC) is building a new \$32,000,000 Therapeutic School and Center for Autism Research campus in the Illinois Medical District (IMD) that will help meet the needs created by the explosive growth in autism. This unique facility is the only one of its kind to combine on a single campus educational, research, training, early intervention, school-to-work transition and independent living capabilities.

The new state-of-the-art 87,000 square foot Therapeutic School and Center for Autism Research campus incorporates a therapeutic school, specially-designed research capabilities, ESMC administrative offices as well as independent living facilities in Phase IV of the project. Phase I of the project was completed in the summer of 2008.

**Nowhere else in the USA is there located in the heart of a major Medical District a campus that contains services for people with autism that provides:**

- Cutting edge education, intervention and treatment programs
  - Easter Seals has designed a special curriculum for children with autism in line with the Illinois State Board of Education standards
- A facility custom designed to meet the special needs of students with autism, emotional behavior disorders and severe learning disabilities
- Interior plans and features from special acoustic finishes and lighting fixtures to therapy and gross motor skills rooms will help reduce distractions and promote more effective learning for children with autism who may be hyper sensitive to light and sound distractions
- World-class education and training seminars which will enable Easter Seals to be the world leader in the latest treatments and training techniques
- School-to-work and vocational training job placement
- Independent Living facilities in Phase IV of the Project
- And perhaps most important, cutting edge research conducted by the finest autism researchers in the USA at the University of Illinois whose mission will be to find the causes, develop interventions and treatments and ultimately eradicate this major disability
  - Clinical affiliation with a major university / hospital such as that afforded by Easter Seals' Affiliation Agreement with the University of Illinois
  - For the past two years, Easter Seals students have participated in the "Listening Project", developed and conducted by Dr. Stephen Porges, Director, Brain-Body Center, Department of Psychiatry University of Illinois at Chicago. Students involved in the project have demonstrated significant, positive changes in the ability to learn, communicate, cope and adapt to living with autism
  - Researchers will be able to unobtrusively observe students at the school in order to find the causes and develop treatments for the disability of autism

- This campus will have state, national and worldwide importance as we stream in “real time” the latest treatments, research techniques and assessments throughout the entire world

These special features make Easter Seals Metropolitan Chicago’s Therapeutic School and Center for Autism Research a “one-of-a-kind” project that we strongly believe will change the world!

The new facility will greatly enhance and expand Easter Seals’ existing Autism Therapeutic School programs. Easter Seals is a premiere agency that currently has Autism Therapeutic Schools in Chicago, Rockford, Tinley Park and Waukegan which provide educational and therapeutic services to over 160 children with autism.

Easter Seals is the premiere vendor of the Chicago Public Schools which, along with surrounding school districts, contracts with Easter Seals to assist in providing educational programs for children with autism who need an alternative school placement to help them grow toward independence. The services and programs provided in the Easter Seals schools include:

- Small Teacher / Student Ratio
- Education
- Speech, Language and Communications Therapy
- Occupational Therapy
- Behavioral Intervention
- Social Work
- Health Related Services
- Transitional Services from School to Work
- Special Olympics
- Sensory Integration

You can be an important part of this world class project. Donate to the new Therapeutic School and Center for Autism Research online at [eastersealschicago.org](http://eastersealschicago.org). You can also print the donation form from the Web site and mail your donation to:

Easter Seals Metropolitan Chicago  
 1939 West 13<sup>th</sup> Street  
 Suite 300  
 Chicago, IL 60608

F. Timothy Muri  
 President & CEO  
 312-491-4137

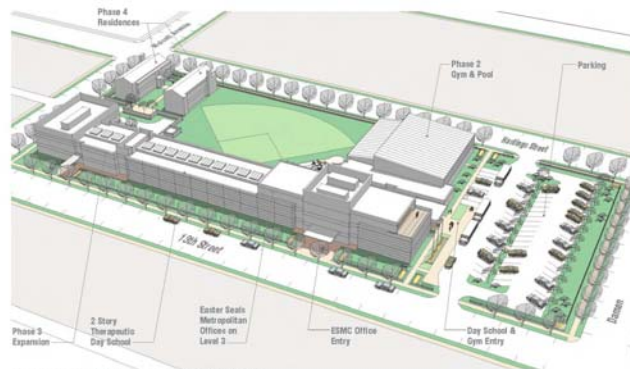

PHASE 4 - FULL MASTERPLAN WITH RESIDENCES



PHASE 3 - GROWTH TO 250 STUDENTS



PHASE 2 - POOL & GYM



PHASE 1 - 150 STUDENTS